

## Libra Sheath – Prescription

All Libra Sheaths come with a measuring guide and 30 hair protectors as standard.

Code	Style	Size	Quantity	PIP Code
GBLSS24	Standard	24mm	30	388-2461
GBLSS28	Standard	28mm	30	388-2479
GBLSS31	Standard	31mm	30	388-2487
GBLSS33	Standard	33mm	30	404-4046
GBLSS35	Standard	35mm	30	388-2495
GBLSS40	Standard	40mm	30	388-2530
GBLSW24	Wide Band	24mm	30	388-2560
GBLSW28	Wide Band	28mm	30	388-2578
GBLSW31	Wide Band	31mm	30	388-2586
GBLSW33	Wide Band	33mm	30	404-4061
GBLSW35	Wide Band	35mm	30	388-2594
GBLSW40	Wide Band	40mm	30	388-2602
GBLSP24	Pop On	24mm	30	388-2511
GBLSP28	Pop On	28mm	30	388-2529
GBLSP31	Pop On	31mm	30	388-2537
GBLSP33	Pop On	33mm	30	404-4053
GBLSP35	Pop On	35mm	30	388-2545
GBLSP40	Pop On	40mm	30	388-2552

Check out our *Libra Sheath Usage Video* here:



Great Bear Healthcare Ltd  
1 Lambourne Crescent,  
Cardiff Business Park,  
Cardiff, CF14 5GF  
T +44 (0) 29 2074 7770

mail@gbhl.co.uk  
www.greatbearhealthcare.co.uk

LIBRASHEATHQUICKGUIDEVZ/2019

 **Great Bear**<sup>®</sup> Healthcare

# Libra Sheath

*A Quick Look Guide*



*The Libra Sheath is available in a range of styles and sizes and is designed to help men manage their continence issues*

## Usage Instructions



1. Wash hands thoroughly



2. Use measuring guide to ensure correct size Sheath



3. Trim pubic hair or use hair protectors provided



4. Use Barrier Wipe (if using) and avoid the glans



5. Remove Sheath from pack, and take off the cone

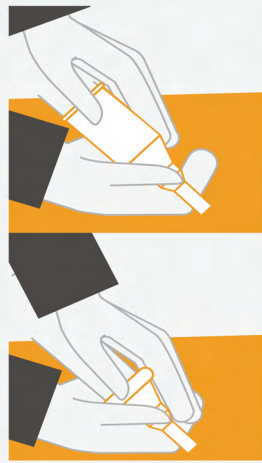

6. Unroll the Sheath along the penis and hold in place for 10 seconds

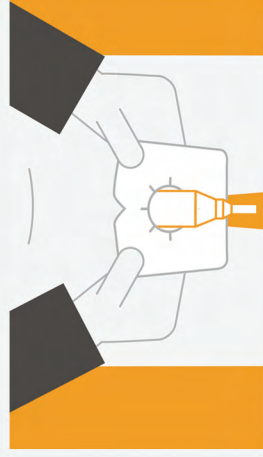

7. Remove hair protector by tearing

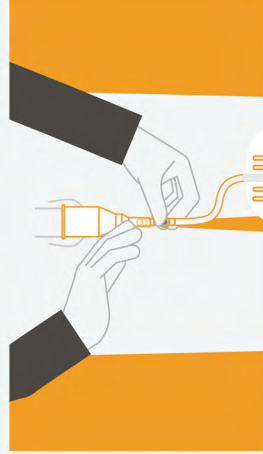

8. Connect the Leg Bag



9. Change Sheath every 24 hours



10. To remove, use warm, soapy water and/or an adhesive remover spray, and gently roll the Sheath off the penis